

DRY-CABINET

English

INSTRUCTION MANUAL

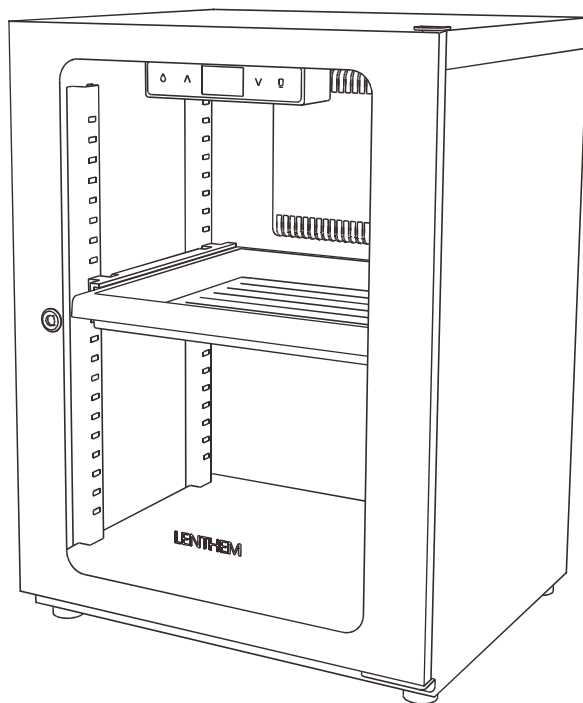

LENTHEM

For Your Care

CATALOG

Thank you for choosing LENTHEM!
Using correctly and proper maintenance
can help extend product life. Please
read the manual before use, and use
it strictly in accordance with the manual.

SAFETY REGULATIONS	3-4P
NAME OF EACH PARTS	5P
REFERENCE HUMIDITY FOR STORING	6P
OPERATING THE DRY CABINET	7P
MAINTENANCE OF CABINET	8P
TROUBLE SHOOTING	9P
REPLAYCEMENT OF PARTS	10-11P

SAFETY REGULATIONS

⊘ Please do not operate like this

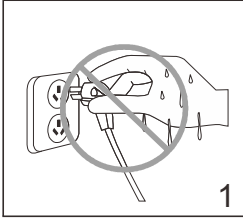

1. Do not plug or unplug with wet hand.

2. Do not place the cabinet near a heat source or sunlight exposure.

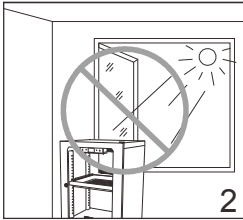

3. Do not put other items blocked or covered the moisture absorption hole or wet discharging hole of the dry unit.

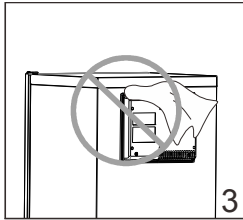

4. Do not place the cabinet at the rough place.

5. Do not exceed a specified voltage range in the case of using the cabinet. (applicable voltage range: 110V/220V)

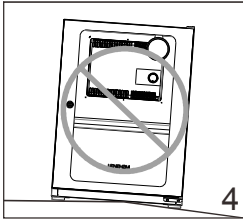

6. Do not put the volatile or flammable materials in the cabinet.

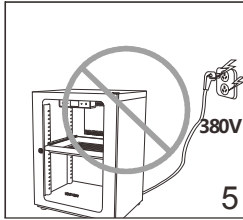

7. Do not drag to damage the power cord.

8. Do not disassemble repair the electronic dry cabinet or reconstruct it.

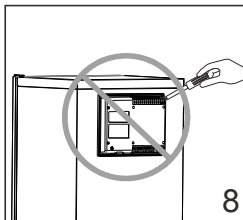
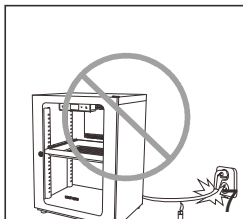
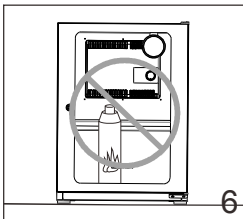

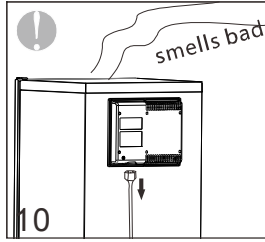
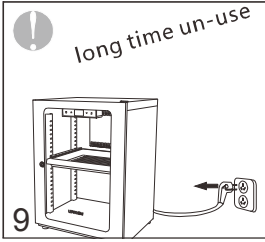

● To follow the operations illustrated.

9. Plug out from electrical outlet while long time un-use.

10. When the electronic dry unit smokes or smells bad, plug out.

11. When opening and closing doors, please confirm whether there are other people touch the cabinet, in case the door clips to the fingers.

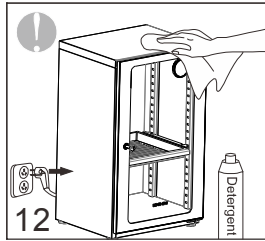
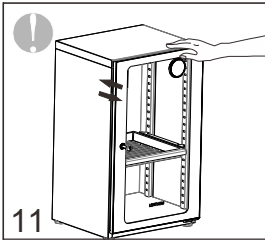

12. While cleaning the cabinet, please unplug the power plug, and use a neutral cleaning liquid to clean, do not use corrosive cleaning fluid to clean.

13. When the cabinet is located against the wall, need to keep 50mm distance from the wall to prevent moisture inside cabinet from draining away, effects of moisture absorption effect.

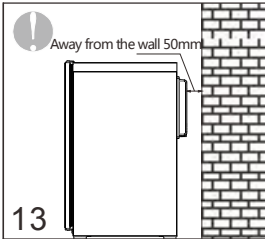

14. Clean out the cabinet every month, clean the dust away from exhaust is very importance.

NAME OF EACH PARTS

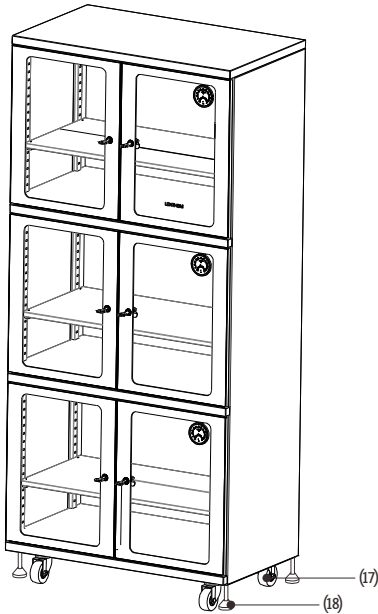
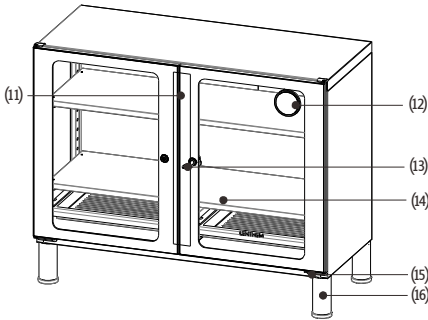
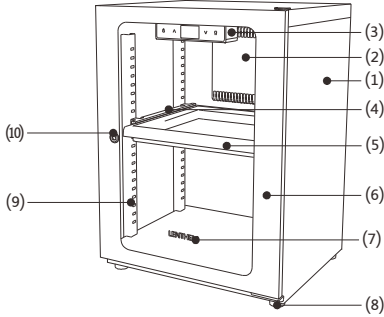

- (1)Main dry cabinet
- (2)Electronic dry unit
- (3)Touching control box
- (4)Plastic guide rail
- (5)Plastic tray
- (6)Tempered glass door
- (7)Logo
- (8)Adjustment plastic leg
- (9)Support bar
- (10)Door lock
- (11)Vertical beams
- (12)Humidity gauge
- (13)Key
- (14)Metal shelf
- (15)Removable door hinge
- (16)Adjustment aluminium leg
- (17)Casters
- (18)Supporting foot

Humidity reference

High humidity, prone to mildew hairy

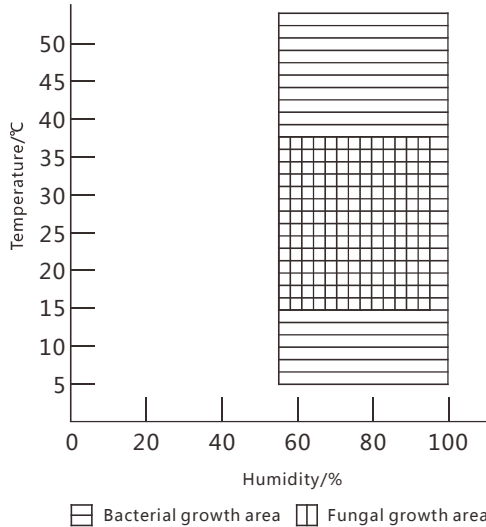

- 55%—60% RH Printing, antique, money, old book, fax paper, copy paper, etc.
- 40%—55% RH Camera, video camera, lens, microscope, endoscope, binocular, magnetic tape, disk, record, film, negative & positive film, musical instrument, stamp, fur, etc.
- 35%—40% RH Precision die, measure instrument, all electronic parts, pc board, metallic powder, etc.
- 35%RH 以下 Sample, standard measuring tool, pollen, seed, etc.

OPERATING THE DRY CABINET

Dry unit control panel Humidity adjustment knob

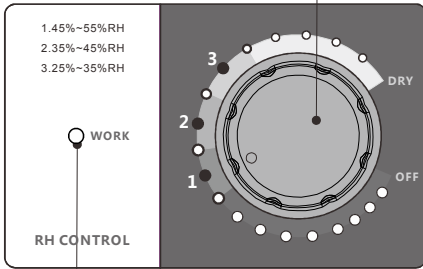

Work lamp

Humidity gauge Humidity indicator area

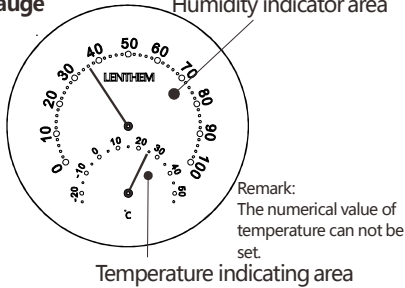

Temperature indicating area

Touch panel

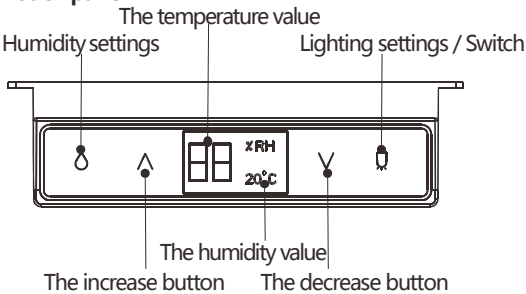

Mechanical dry unit

1. Plug the power cord into a 220V/110V power outlet.
2. The humidity switch knob on the dry unit from "OFF" to "DRY", clockwise twist to the desired humidity gear. (1 for 45%-55% RH, 2 for 35%-45%RH, 3 for 35%RH or less), When the red light is on, the cabinet began operations, dry unit begin to the outside row of wet heating.
3. After running for half an hour, page door open inward, and began to absorb moisture. Moisture absorption period is 6 hours.
4. During this period confirm that the humidity in the cabinet has dropped to a lower range, then put the items into the cabinet and shut the door.

Touch dry unit

1. Plug the power cord into a 220V/110V power outlet.
2. The LCD display on the touch control box will flash once, the dry unit began operation, page door open outward to the outside row of wet. Then you can control the humidity settings by pressing the buttons on the box panel, "Δ" three seconds to enter the humidity setting interface, adjusts to the desired value by press the "∧" button or "∨" button, Press the "Δ" button once again, the humidity is saving, and then return back to the present humidity display. Touch button "⏏" three seconds to enter the LED lighting time setting, press "∧" or "∨" settings, touch the "⏏" can be turned on LED lighting.
3. After running for half an hour, pages door open inward, and began to absorb moisture. Moisture absorption period is 6 hours.
4. During this period confirm that the humidity in the cabinet has dropped to a lower range, then put the items into the cabinet and shut the door.

MAINTENANCE OF CABINET

Before maintenance

- Please disconnect the power of dry cabinet.

When maintenance

- External cabinet

Please use warm water, neutral detergent and a soft cloth to wipe the outside of cabinet, then wipe dry with a clean soft cloth.

- Door seals

The dust on top of the door seals due to the gravity of the reason, easy accumulation. Or when stacked medicines and foods, some scattered powder will adhere to the above, door seals will be more or less compression and friction in the process of attracting, leading to the door seal is not sealed, causing the cabinet is not airtight, therefore, we should usually wipe the door seal with soft cloth with water, and wipe clean with a dry cloth.

- Internal cabinet

Trays, shelves, drawers and other bearing components, should be cleaned regularly to avoid powder is absorbed into the internal dry unit, causing a short circuit or decreased the dehumidification performance.

- Do not use the following items to clean the dry cabinet

Alkaline or weakly alkaline cleaning liquid, scouring powder, washing powder, abrasive paste, oil and refined oil, boiling water, acids, organic solvents, toothpaste and other easily damaged cabinet surface.

- When stained with grease, please erase

If not promptly erased, may lead to cracking of the plastic parts.

After maintenance

- Check the power cord is damaged? If the wire or plug had been cracked, please replace it at once to avoid fire or shock.
- Check the power outlet or plug if there are unusual heating phenomenon, and if so, immediately unplug the plug and check the cause.
- Plug out from electrical outlet while long time un-use.
- Power plug is plugged in?

TROUBLE SHOOTING

What problems might occur?

I.No display

- 1.Has the switch of electronic dry unit been connected?
- 2.Is the dry cabinet properly plugged in?
- 3.Has the fuse melting off or the electronic dry unit been operated?
- 4.Does the work lamp of electronic dry unit work?(mechanical control)

The reason

- 1.No rotation the humidity switch, power supply without conducting, the dry unit was off state and does not work.
- 2.The power cord is not plugged into the power outlet, the cabinet without power supply.
- 3.The fuse melting off, the equivalent circuit is disconnected, no loops produce.
- 4.When the setting humidity value reaches or exceeds the humidity of the cabinet, the dry unit will automatically power-off, while inside humidity rises, the unit will automatically energized, indicator lights, active dehumidification.

II. Humidity does not drop down to the set value

- 1.Is the humidity level correctly set?
- 2.Is the door of the dry cabinet tightly closed?
- 3.Is the door of the dry cabinet frequently opened?
- 4.Do the items inside the cabinet contain a lot of moisture?

The reason

- 1.When the humidity is not set in the desired range, the dry unit will stop energized and could not achieve the desired humidity value.
- 2.The door of the dry cabinet is not completely closed, the outside moist air will enter the cabinet, resulting humidity cannot be decreased to the desired value.
- 3.Frequently open and close doors, the outside air continuously into the cabinet, and dry unit will take some time before slowly decreased.
- 4.Items placed containing high water causes water molecules constantly released, humidity rate of decline will be affected.

III. Humidity inside the cabinet did not come down

Humidity setting higher than the outside is invalid, because the cabinet does not have the humidification function.

REPLACEMENT OF PARTS

Replacement of dry unit

1. Pull out the power supply plug.
2. Pull out the connectors of the electronic dry unit.
3. Disassemble the 6 screws of electronic dry unit.
4. Then the electronic dry unit is separated.

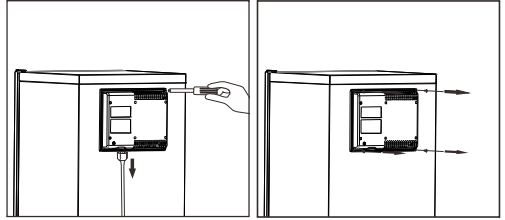

Replacement of touching control box

1. Disassemble the 4 screws of touch control box,
2. Pull out the connectors of the electronic dry unit,
3. Then the touching control box is separated.

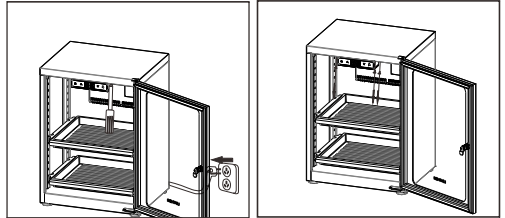

Transposition and installation of metal shelf or tray

1. First of all, please remove the vertical beams in the middle of the cabinet, pull out with force from the bottom, after the separation of the bottom, then pull down, and the vertical beams can be removed.

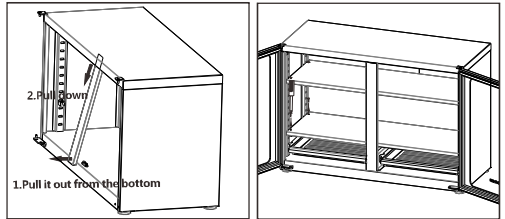

2. If you need to replace the location of metal shelf, first lift the metal shelf one end, then pull out the four shelf clasp, and then buckle into the want height, insert the clipping hole on the support bar . Note placed at the same height, otherwise the plate back will not smooth. As for the transposition of plastic tray, you need to first remove the tray along the rails, and then guide rail and support parallel tilt removed, insert the appropriate height of the clipping hole, then push the tray along the slide track to complete the transposition .

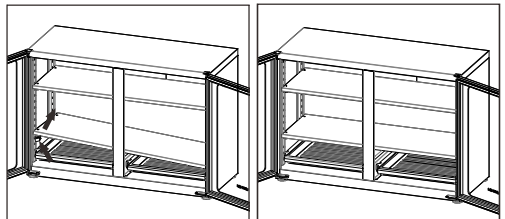

3. For the first installation, the steps are basically similar with replacing shelf and tray, but no need to lift the metal shelf or pull out the tray.

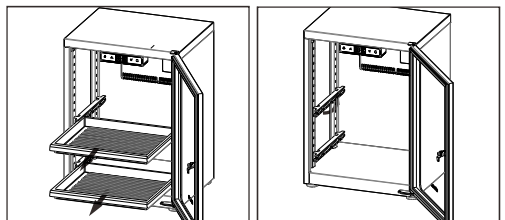

Replacement and installation of adjustment aluminium leg

1. First, remove the plastic leg in a clockwise direction.
2. Remove the adjustment aluminium leg, screw on the plastic leg at the bottom of the cabinet counterclockwise into the screw hole and tighten.
3. If you do not need the adjustment aluminium leg, then reverse the two steps above.

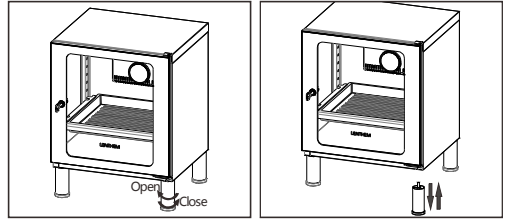

LENTHEM

ZHUHAI HIGH-TECH ZONE LENTHEM TECHNOLOGY CO.,LTD.

Tel: +86-756-366 8845 Fax:+86-756-366 8851

E-mail: info@lenthem.com

www.lenthem.com